

PART 3. APPLICATION FOR EXHIBITION

Your Details

Title _____ Full Name _____
 Address _____
 Suburb _____ Post Code _____
 Email _____
 Phone _____ Mobile _____

Are you a member? Yes No

Do you intend to have your works for Sale? Yes No

Do you have an ABN? No Yes > _____

Are you Registered for GST? Yes No

Your Exhibition Details

Title of Exhibition _____
 Exhibition Rationale (300 words or less)

Artist Statement (100 words or less)

Proposed Dates
 1st Choice _____ 2nd Choice _____ 3rd Choice _____

Special Requirements (*Plinths, Lighting, Suspension, Alterations*)

Proposed Space Main Space Access Space Vault Space Stairwell Space

On the floorplan below, please indicate the preferred space and the proposed location of each artwork in the exhibition.

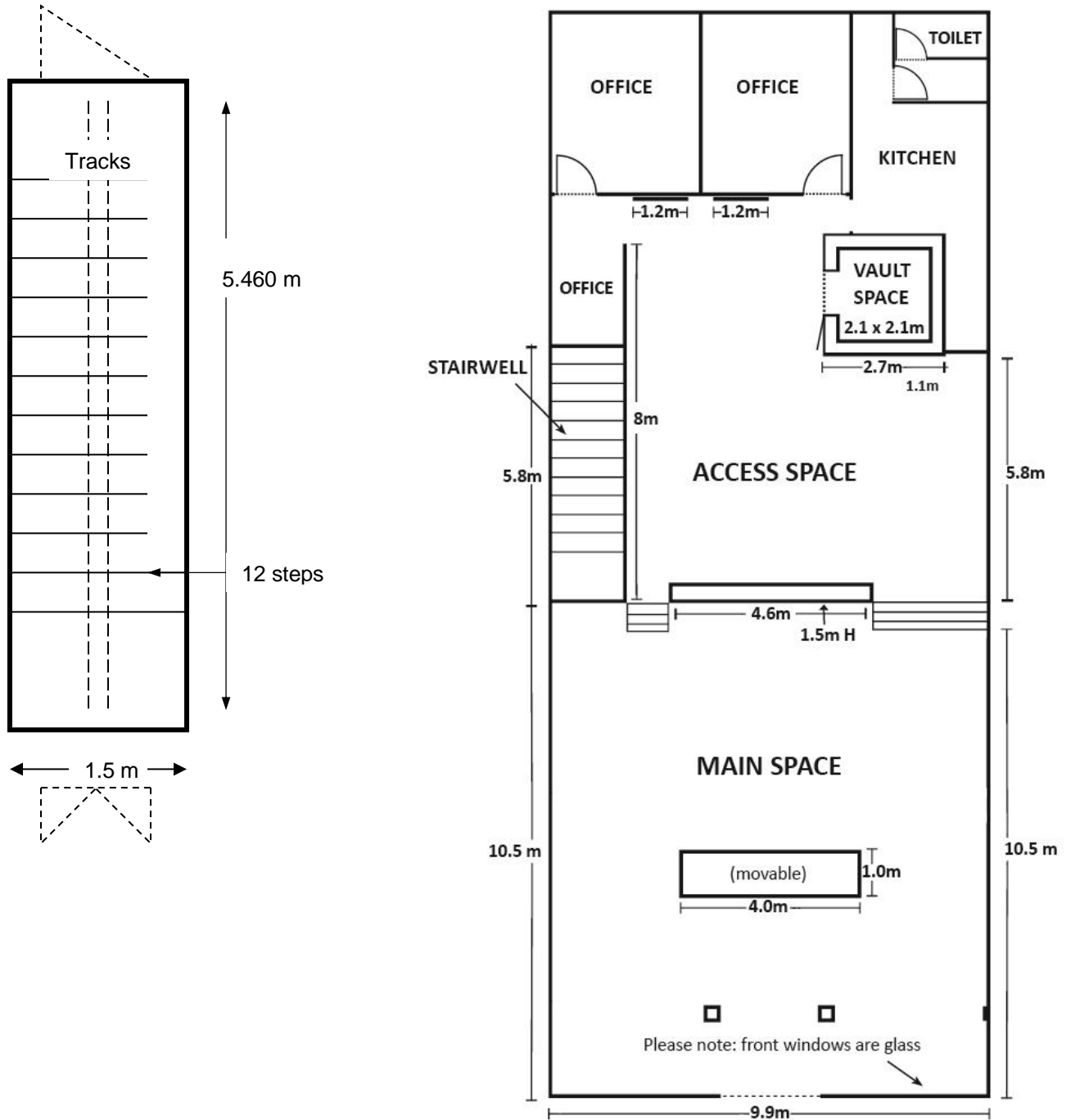

Z:\Shared\Forms & Templates\Umbrella Measurements

Please ensure you include the following in your Exhibition Proposal when you submit it for assessment:

Solo Exhibitions:

- Completed Application Form (Part 3 – 2 pages)
- Cover letter that briefly outlines key points from proposal
- A current CV and brief artist biography (no more than two A4 pages in total).
- Visual support material:
 - 5 images each clearly identified as previous work indicative of work proposed for exhibition;
 - 5 images each clearly identified as work proposed for exhibition. These can be in-progress images/sketches or completed work.
 - Hard copy listing of each above artwork details, eg. artist's name, artwork's title, year completed, mediums and scale

The images should be photographs or scanned sketches in digital format (jpeg or Tiff format) that can be added to the same disc as your power point.
- Visual support material should also be presented on a clearly labelled CD as a power point or pdf file, and on the same CD separate jpeg or Tiff files. Each image should be clearly labelled with artist's name, artwork's title, year completed, mediums and scale. Accepted file formats: .JPEG, .TIFF, .PPT, .PPTX, .PDF. *Not Accepted: Any other formats including .KEY, .ODP, etc*
- Any other support material you wish to provide
- Stamped self addressed envelope for the return of support material for unsuccessful applications

Group Exhibitions:

- Completed Application Form (Part 3 – 2 pages)
- Cover letter that briefly outlines key points from proposal
- A CV and brief biography of each artist presented on one page
- Visual support material:
 - 2 images from each artist each clearly identified as previous work, indicative of, but not those proposed for exhibition;
 - 2 images from each artist each clearly identified as proposed works for exhibition. These can be in-progress images/sketches or completed work.

The images should be photographs or scanned sketches in digital format (jpg or Tiff format) that can be added to the same disc as your power point.
- Visual support material should also be presented on a clearly labelled CD as a power point or pdf file, and on the same CD separate jpeg or Tiff files. Each image should be clearly labelled with artist's name, artwork's title, year completed, mediums and scale. Accepted file formats: .JPEG, .TIFF, .PPT, .PPTX, .PDF. *Not Accepted: Any other formats including .KEY, .ODP, etc*
- Any other support material you wish to provide
- Stamped self addressed envelope for the return of support material for unsuccessful applications