

umbrella studio

Umbrella Studio invites exhibition proposals from established and emerging contemporary visual artists and curators seeking to present new and original artwork in a professional gallery environment.

Application Guidelines

Solo Exhibition

To make an application to exhibit at Umbrella Studio please submit the following:

- Cover letter that briefly outlines key points from proposal

Exhibition Proposal containing:

- A current CV and brief artist biography (no more than two A4 pages in total) containing artist's name and contact details
- Title of exhibition and exhibition rationale (300 words or less)
- Artist statement (100 words or less)
- Visual support material: 5 images each clearly identified as previous work indicative of work proposed for exhibition and 5 images each clearly identified as work proposed for exhibition: in-progress images/sketches or completed work. Slides, photographs, sketches, jpg files are accepted however Umbrella Studios encourages visual support material to be presented in a power point file, each image clearly labelled with artist's name, artwork's title, year completed, mediums, scale. Visual support material should also be accompanied with a hard copy listing of each artwork's details
- Umbrella Studio floor plan indicating the preferred space and the proposed location of each artwork. See: <http://umbrella.org.au/info/facilities/floorplan>
- Preferred dates: 1st, 2nd, 3rd choices
- Any special requirements (plinths, lighting, suspension, proposed alterations etc)
- Other support material
- Stamped self addressed envelope for the return of support material and unsuccessful applications

Group Exhibition

Group proposals should include the information as for Solo proposals, except for specific cv and visual support requirements as outlined below:

- a cv and brief biography of each artist presented on one page
- 2 images from each artist each clearly identified as previous work, indicative of, but not those proposed for exhibition
- 2 images from each artist each clearly identified as proposed works for exhibition (may be in-progress images and sketches)
- All images to be clearly labelled with artist's name, artwork's title, year completed, mediums, scale. Umbrella Studio encourages visual support material to be presented in a clearly labelled powerpoint on cd.

Assessment Criteria

Exhibition applications will be assessed by the following assessment criteria, presented here in order of significance from highest to lowest.

Key criteria:

- Conceptual and aesthetic innovation
- Potential for public program and professional development opportunities for local artists
- The exhibition will extend visitors' knowledge and appreciation of contemporary visual arts
- The exhibition fulfils professional, non commercial, gallery standards

Desirable criteria:

- The exhibition is not motivated most significantly by commercial interests/outcomes
- The majority of works should not have been exhibited elsewhere in the region and not be very similar to work previously exhibited locally

Submitting Proposals

Umbrella Studio accepts proposals twice yearly. Applicants are welcome to make an appointment to discuss their proposal with staff prior to its submission. The first round closes on 19 April and the second round on 19 October each year.

Emailed or faxed proposals will not be accepted.

All applications are reviewed by a Program Sub-committee. Successful applicants will receive a letter detailing their exhibition arrangements. Unsuccessful applicants will receive an assessment feedback sheet outlining the strengths and weaknesses of their application.

Please send applications to:

**Umbrella Studio Association Inc.
PO Box 2394
Townsville
QLD 4810**

For further information please telephone 07 4772 7817 or email info@umbrella.org.au

On the floorplan below, please indicate the preferred space and the proposed location of each artwork in the exhibition.

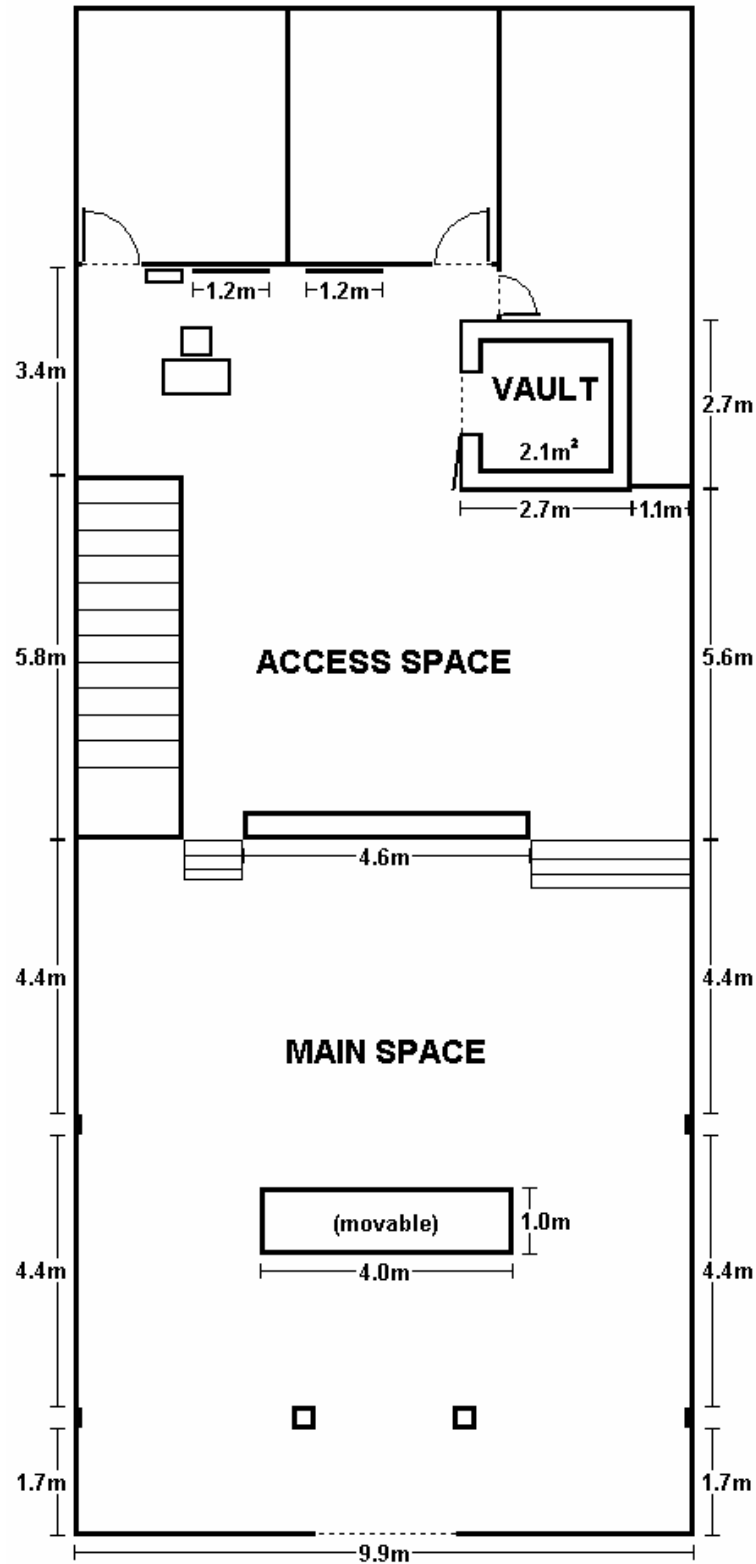

Submission Guidelines

Please ensure you include the following in your Exhibition Proposal when you submit it for assessment:

- Completed Application Form
- Completed floorplan with indication of required space and artwork placement
- Cover letter that briefly outlines key points from proposal
- A current CV and brief artist biography (no more than two A4 pages in total).
- Visual support material: 5 images each clearly identified as previous work indicative of work proposed for exhibition and 5 images each clearly identified as work proposed for exhibition: in-progress images/sketches or completed work. Slides, photographs, sketches, jpg files are accepted however Umbrella Studios encourages visual support material to be presented in a power point file, each image clearly labelled with artist's name, artwork's title, year completed, mediums, scale. Visual support material should also be accompanied with a hard copy listing of each artwork's details
- Other support material
- Stamped self addressed envelope for the return of support material and unsuccessful applications

Also note that if your work is selected, it is a requirement that you become an Umbrella Member to exhibit.

Please submit your completed Exhibition Proposal to:

**Umbrella Studio Association Inc.
PO Box 2394
Townsville
QLD 4810**

Umbrella Studio
482 Flinders Street, Townsville QLD 4810
PO BOX 2394 Townsville QLD 4810
Ph: 07 4772 7817 Fax: 07 4772 7109